



FACTORY-INSTALLED EQUIPMENT

- 2 Prevost Installed Slide Outs (Electric Motors and Pneumatic Seals)
- 1 Front and 1 Rear Regular OR Super Slide
- Prevost-Patented Frameless Side Windows, Electrical Awnings
- Front Cap Without Small Side Windows
- Fog Lights
- Driver's Window Blinds
- Electric Windshield Blinds LH and RH
- Ramco® Remote Heated Rearview Mirrors:
w/Separate Convex Top Chrome
- Central Electrical Door Locking System
- Remote Keyless Locking Entrance Door
- Remote Keyless Locking Compartment Doors
- Trailer Hitch Package (20,000 lbs.)
- Dual License Plate Holder
- Turn Signal Lights/Side Marker Lights (6)
- Cornering and Docking Lights
- Courtesy Lights Blinker Switch
- Engine and Compartment Lighting
- ISRI Air Ride Driver Seat 6832
- Exterior Graphic Design
- Back-Up Sound Alarm
- Hot Water Booster Pump
- Headlamp Cleaning System

POWERTRAIN

- EPA US10 compliant Volvo D13 Engine 500HP with Diesel
 - Particulate Filter (DPF) and Selective Catalytic Reduction (SCR)
 - Engine Torque Rating (ft.-lb.) 1750
 - Engine Warranty 5 yr./250,000 mi
- Allison® World 4000 MH, 4th Generation
 - 6-Speed Automatic Transmission Warranty 5 yr./200,000 mi
- Allison® Hydraulic Transmission Retarder
- Cruise Control
- Pneumatic Drive Belt Tensioners
- Turbo-Boost Gauge
- Electric Starting Aid
- 3-speed Engine Cooling Fan
- Engine Coolant Filter
- Block Heater
- Two-Step Dual Filter with Water Separator
- Prevost Liaison

TIRES/WHEELS

- Michelin® 315/80R22.5 (Drive Axle)
- Michelin® 365/70R22.5 (Front & Tag Axle)
- Aluminum Rims 22.5"x9" (Drive Axle)
- Aluminum Rims 22.5"x10.5" (Front & Tag Axle)

BRAKES

- All Wheel Disc w/ABS
- Front Wheel Brake Boosters (Type 27)
- Drive Wheel Brake Boosters (Type 24-24)
- Tag Wheel Brake Boosters (Type 14-16)
- Parking Brake Booster on Tag Wheels

STEERING/SUSPENSION

- Tilt and Telescopic Steering Wheel
- ZF Variable Assistance Power Steering System
- Independent Suspension System
- Front and Drive Axle Sway Bars
- Integrated Pneumatic Level - Low Levelling System
- Liftable Tag Axle
- Splash Guards Between Drive & Tag Axles and Behind Front Axle
- Rear End Ratio 4.10

ELECTRICAL SYSTEM

- Fully Multiplexed Electrical System
- 12v Exterior Lighting
- 24v Main System
- Driver's A/C System with Quadruple Bosch 24V/120 AMP Alternator

INNOVATIVE SAFETY FEATURES

- Prevost Electronic Stability Program (ESP)
- Automatic Fire Suppression System
- Beru Tire Pressure Monitoring System
- Xenon Low Beam Headlights

GENERAL

- Overall Length 45'
- Wheelbase 334.5"
- Overall Width 102"
- Overall Height 143"
- Floor-to-Ceiling Height (Finished) 85"
- Cabin Floor Height 48.5"
- Usable Cabin Flat Floor (Finished) 288 sf.
- Under-Floor Storage (w/Driver A/C) 433 cu ft.
- Underfloor Compartment Doors Width 70 5/8"
- Entrance Door Width 30"
- Ground Clearance 11"
- Overhang (Incl. Bumper) - Front 68.75"
- Overhang (Incl. Bumper) - Rear 82.75"
- Turning Radius 44.3"
- State-of-the-art Soundproofing
- Fuel Tank (US Gal) 208
- Fuel Fill, Both sides
- Generator Hook-up on Main fuel Tank
- Full Dash A/C, Condenser w/Copper Fins,
Cooling Capacity 108,000 BTU/Hr.
- A/C Refrigerant 134A
- Gross Vehicle Weight Rating (lbs.) 55,500
- Wet Weight, w/Full A/C (lbs.) 32,200
- Axle Design Load Capacity-Front (lbs.) 19,000
- Axle Design Load Capacity-Drive (lbs.) 22,500
- Axle Design Load Capacity-Tag (lbs.) 14,000
- Roof Exhaust Extension 9"
- Body Construction Structure:
 - Integral Stainless/Rust Protected Mild Steel
 - Luggage Doors: Stainless Steel Ribbed Between
 - Luggage Doors and Windows: SS stretched
 - Body Construction-Outer Shell :
 - Stainless Steel to Bottom of Windows
 - Body Construction Sub-Frame:
 - Low-Alloy/High Tensile Steel
 - Baggage Bay Door Interior Aluminum Lining
 - Aluminum Partitions Between Baggage Compartments
 - Aluminum Floor Liner in Bays



**X3-45 SERIES COACH
Super Slide**

CONVERSION SPECIFICATION

VIN #5909

EXTERIOR

(4) Roof Mounted Power Awnings with Motion Sensors
Front and Rear Roof Cowlings
Roof Mounted Air Horns
Stainless Steel Rub Package w/LED Lights
Mud Flaps with Weights and Stainless Steel Trim
Auto Leveling System
Docking Lights
Bay Areas are Carpeted
Slide Out Trays in Storage Area
(4) Zip Dee® Chairs in Custom Built Storage

CUSTOM EXTERIOR GRAPHICS & PAINT

Base Coat/Clear Coat Standox® Paint
Custom Painted Graphics with Super Clear Coat

PLUMBING SERVICE BAY

Utility Bay:
City Water Inlet
Auto Tank Fill
Water Manifold System
Soap and Towel Dispensers
Black Tank Rinse

DASH-ENTRY

Custom Upholstered Dash
Illuminated Dash Panel
Custom Interior Entry Door Panel
Electric Privacy Shades for Driver and Passenger Windows
Steering Wheel Controlled Driver and Passenger Sun Shades
Knoedler Air Chief Driver Seat
Swivel Passenger Seat Heated and 6-way Power with Power Foot Rest
Electric Step Well Cover, Switch at Driver and Passenger Area
40 Channel Cobra® CB Radio
Navigation System including:
Color Backup Camera & Trailer Camera Kit
Bluetooth Technology
XM/AM/FM Player
iPad Control & Docking Station

INTERIOR LIGHTING

LED Ceiling and Cabinet Down Lighting with Variable Control
Accent and Aisle Lighting Throughout Interior
Custom Window Lighting Throughout Interior
Reading Lights in Bedroom

BEDROOM

Electric Blackout Shades
Quilted Bedspread with Designer Pillows
King Bed
Nightstand
Wardrobe w/Drawer
Walk-In Closet w/Drawers
Safe

SALON/GALLEY

(1) Custom Sofa Sleeper & (1) Custom Dinette
(2) Euro Chairs & End Table
Corian Countertops
Tile Backsplashes
Designer Kitchen Sink with Sink Cover and Custom Faucets
Refrigerator 10.2 cu ft
2-Burner Induction Cook Top Recessed with Cover
Pre-Plumbed for Dishwasher
Built-In Convection Microwave Oven
Combo Washer and Dryer
Electric Custom Window Covering
Custom Wood Floors
Slideout Pantry
Slideout Trash Can

ELECTRICAL

Charging and Power:
40 AMP 24v Charger for Main Engine Batteries
75 AMP 24v Alternator for Main Engine Batteries
(2) 75 AMP 24v Alternator for House Batteries
50 AMP Automatic Power Transfer Between Generator & Shoreline
with Generator Priority and Manual Override
50 AMP Breaker Panel for Generator & Shoreline
(4) 12v Deep Cycle 8D Lifeline 255 AMP/hr. Batteries
(2) 3.5K Inverters (7,000W or 7KW) will Operate:
Front Air Conditioner
Televisions/Entertainment System (Salon, Bed, & Bay)
110v AC Receptacles
Refrigerator
Water Pump
Microwave
Power Management System with Monitors:
DC Battery Voltage
Holding Tank Levels
Generator Operation (AGS)
20KW Power Tech® Diesel Generator with Air Bag Suspension

CEILING, WINDOWS, & WALL TREATMENTS

Electric Shades with Custom Treatments on All Windows
Suede Ceiling
Suede & Vinyl Walls
Designer Tile Backsplash in Kitchen
Solid Surface Window Sills
Designer Vanity Backsplashes and Tile Walls in Bathroom
Tile Walls in Bathroom

AUDIO-VIDEO

Blu-Ray DVD with Sound Bar in Salon/Bedroom/Entertainment Bay
Stationary TV Antenna
(1) In-Motion Satellite System
(2) Stationary HD Satellite System
46" LED HD Television in Bedroom on Lift
46" LED HD Television in Entertainment Bay
46" LED HD Television on Lift in Cab for Salon
Crestron® System with 3 iPad Controls with Docking Station for:
Audio/Video in Salon/Bedroom/Entertainment Bay
XM/AM/FM Player
Window Shades
Lighting
Climate Control HVAC

AIR CONDITIONING & HEATING

(4) Low Profile 13,500 BTU Roof Air Conditioner with:
Heat Pump and Dual Control Module
50,000 BTU Diesel Fired Boiler Hydronics System
(3) Interior Zones and (1) Utility Bay Zone
(7) Heat Exchangers
Electric Heater for Plumbing Bay
110v Electronic Heater in Step Well, Bathroom, and Kitchen Base

PLUMBING

153 Gallon Fresh Water Tank
126 Gallon Total Holding Tanks
63 Gallon Gray and 63 Gallon Black Water Tanks
Driver Side Electric Dump Valves for Gray and Black Tanks
(2) 10 Gallon Electric Water Heater with Winterization System & Motor Aide
110v Water Pump with Accumulator Tank 65 PSI
12v Back Up Water Pump
Water Filtration System

BATHROOM(S)

Custom Sinks and Faucets
Custom Shower Walls with Seat and Shampoo Caddy
Pressure Balanced Shower Valve with Slide Bar
Bath Accessory Package
(2) Tecma® Toilet
(2) Exhaust Fan
Custom Glass Shower Door

OPTIONS

Entrance Door Bell and Camera
Ground Effect Lights (White)
Electric Heated Floors



X3-45 SERIES COACH

ADDITIONAL OPTIONS

- Custom Fiberglass Fenders
- Additional Zip Dee® Chairs
- Entrance Door Bell and Camera
- Water Filtration System
- Coffee Maker
- Ground Effect Lights (White or Blue)
- 46" TV Lift Up in Nose
- Expandable "J" Lounge
- Wrap Around Dinette
- Custom Bar with Stools

OPTIONS

- Sub Zero Refrigerator
- Dishwasher Drawer
- Electric Heated Floors
- Air Operated Pocket Doors with Emergency Override
- Wine Chiller
- Portable Grill
- Air Hose and Caddy
- Recliner
- Table & Chairs
- Bunk Beds w/Wardrobe & TV's

- Fireplace
- Electric Slide Out Pantry
- Central Vacuum
- Portable Vacuum
- Wine Cabinet
- Custom Tile Floors
- Swivel Chair(s)
- Bath and Half Floor Plan
- Euro Chair(s) & End Table

FACTORY-INSTALLED EQUIPMENT

2 Prevost installed Slide Outs (Electric Motors and Pneumatic Seals)
 1 Front and 1 Rear Regular OR Super Slide
 Prevost-Patented Frameless Side Windows, Electrical Awning
 Front Cap Without Small Side Windows
 Fog Lights
 Driver's Window Blinds
 Electric Windshield Blinds LH and RH
 Ramco® Remote Heated Rearview Mirrors:
 w/Separate Convex Top Chrome
 Central Electrical Door Locking System
 Remote Keyless Locking Entrance Door
 Remote Keyless Locking Compartment Doors
 Trailer Hitch Package (20,000 lbs.)
 Dual License Plate Holder
 Turn Signal Lights/Side Marker Lights (6)
 Cornering and Docking Lights
 Courtesy Lights Blinker Switch
 Engine and Compartment Lighting
 ISRI Air Ride Driver Seat 6832
 Exterior Graphic Design
 Back-Up Sound Alarm
 Hot Water Booster Pump
 Headlamp Cleaning System

POWERTRAIN

EPA US10 compliant Volvo D13 Engine 500HP with Diesel
 Particulate Filter (DPF) and Selective Catalytic Reduction (SCR)
 Engine Torque Rating (ft.-lb.) 1750
 Engine Warranty 5 yr./250,000 mi
 Allison® World 4000 MH, 4th Generation
 6-Speed Automatic Transmission Warranty 5 yr./200,000 mi
 Allison® Hydraulic Transmission Retarder
 Cruise Control
 Pneumatic Drive Belt Tensioners
 Turbo-Boost Gauge
 Electric Starting Aid
 3-speed Engine Cooling Fan
 Engine Coolant Filter
 Block Heater
 Two-Step Dual Filter with Water Separator
 Prevost Liaison

EXTERIOR

(4) Roof Mounted Power Awnings with Motion Sensors
 Front and Rear Roof Cowlings
 Roof Mounted Air Horns
 Stainless Steel Rub Package w/LED Lights
 Mud Flaps with Weights and Stainless Steel Trim
 Auto Leveling System
 Docking Lights
 Bay Areas are Carpeted
 Slide Out Trays in Storage Area
 (4) Zip Dee® Chairs in Custom Built Storage

CUSTOM EXTERIOR GRAPHICS & PAINT

Base Coat/Clear Coat Standox® Paint
 Custom Painted Graphics with Super Clear Coat

PLUMBING SERVICE BAY

Utility Bay:
 City Water Inlet
 Auto Tank Fill
 Water Manifold System
 Soap and Towel Dispensers
 Black Tank Rinse

DASH-ENTRY

Custom Upholstered Dash
 Illuminated Dash Panel
 Custom Interior Entry Door Panel
 Electric Privacy Shades for Driver and Passenger Windows
 Steering Wheel Controlled Driver and Passenger Sun Shades
 Knocler Air Chief Driver Seat
 Swivel Passenger Seat Heated and 6-way Power with Power Foot Rest
 Electric Step Well Cover, Switch at Driver and Passenger Area
 40 Channel Cobra® CB Radio
 Navigation System including:
 Color Backup Camera & Trailer Camera Kit
 Bluetooth Technology
 XM/AM/FM Player
 IPad Control & Docking Station

INTERIOR LIGHTING

LED Ceiling and Cabinet Down Lighting with Variable Control
 Accent and Aisle Lighting Throughout Interior
 Custom Window Lighting Throughout Interior
 Reading Lights in Bedroom

TIRES/WHEELS

Michelin® 315/80R22.5 (Drive Axle)
 Michelin® 365/70R22.5 (Front & Tag Axle)
 Aluminum Rims 22.5"x9" (Drive Axle)
 Aluminum Rims 22.5"x10.5" (Front & Tag Axle)

BRAKES

All Wheel Disc w/ABS
 Front Wheel Brake Boosters (Type 27)
 Drive Wheel Brake Boosters (Type 24-24)
 Tag Wheel Brake Boosters (Type 14-14)
 Parking Brake Booster on Tag Wheels

STEERING/SUSPENSION

Tilt and Telescopic Steering Wheel
 ZF Variable Assistance Power Steering System
 Independent Suspension System
 Front and Drive Axle Sway Bars
 Integrated Pneumatic Level - Low Leveling System
 Liffable Tag Axle
 Splash Guards Behind Drive & Tag Axles and Behind Front Axle
 Rear End Ratio 4.10

ELECTRICAL SYSTEM

Fully Multiplexed Electrical System
 12v Exterior Lighting
 24v Main System
 Driver's A/C System with Quadruple Bosch 24V/120 AMP Alternator

INNOVATIVE SAFETY FEATURES

Prevost Electronic Stability Program (ESP)
 Automatic Fire Suppression System
 Beru Tire Pressure Monitoring System
 Xenon Low Beam Headlights

BEDROOM

Electric Blackout Shades
 Quilted Bedspread with Designer Pillows
 King Bed
 Nightstand
 Wardrobe w/Drawer
 Walk-In Closet w/Drawers
 Safe

SALON/GALLEY

(1) Custom Sofa Sleeper & (1) Custom Dinette
 (2) Euro Chairs & End Table
 Corian Countertops
 Tile Backsplashes
 Designer Kitchen Sink with Sink Cover and Custom Faucets
 Refrigerator 10.2 cu ft
 2-Burner Induction Cook Top Recessed with Cover
 Pre-Plumbed for Dishwasher
 Built-In Convection Microwave Oven
 Combo Washer and Dryer
 Electric Custom Window Covering
 Custom Wood Floors
 Slideout Pantry
 Slideout Trash Can

ELECTRICAL

Charging and Power:
 40 AMP 24v Charger for Main Engine Batteries
 75 AMP 24v Alternator for Main Engine Batteries
 (2) 75 AMP 24v Alternator for House Batteries
 50 AMP Automatic Power Transfer Between Generator & Shoreline
 with Generator Priority and Manual Override
 50 AMP Breaker Panel for Generator & Shoreline
 (4) 12v Deep Cycle 8D Lifeline 255 AMP/HR. Batteries
 (2) 3.6K Inverters (7,000W or 7KW) will Operate
 Front Air Conditioner
 Televisions/Entertainment System (Salon, Bed, & Bay)
 110v AC Receptacles
 Refrigerator
 Water Pump
 Microwave
 Power Management System with Monitors:
 DC Battery Voltage
 Holding Tank Levels
 Generator Operation (AGS)
 20KW Power Tech® Diesel Generator with Air Bag Suspension

CEILING, WINDOWS, & WALL TREATMENTS

Electric Shades with Custom Treatments on All Windows
 Suede Ceiling
 Suede & Vinyl Walls
 Designer Tile Backsplash in Kitchen
 Solid Surface Window Sills
 Designer Vanity Backsplashes and Tile Walls in Bathroom
 Tile Walls in Bathroom

GENERAL

Overall Length 45'
 Wheelbase 334.5"
 Overall Width 102"
 Overall Height 143"
 Floor-to-Ceiling Height (Finished) 85"
 Cabin Floor Height 48.5"
 Usable Cabin Flat Floor (Finished) 288 sf.
 Under-Floor Storage (w/Driver A/C) 433 cu ft
 Underfloor Compartment Doors Width 70 5/8"
 Entrance Door Width 30"
 Ground Clearance 11"
 Overhang (Incl. Bumper) - Front 68.75"
 Overhang (Incl. Bumper) - Rear 82.75"
 Turning Radius 44.3"
 State-of-the-art Soundproofing
 Fuel Tank (US Gal) 208
 Fuel Fill, Both sides
 Generator Hook-up on Main Fuel Tank
 Full Dash A/C, Condenser w/Copper Fins.
 Cooling Capacity 108,000 BTU/HR.
 A/C Refrigerant 134A
 Gross Vehicle Weight Rating (lbs.) 55,500
 Wet Weight, w/Full A/C (lbs.) 32,200
 Axle Design Load Capacity-Front (lbs.) 19,000
 Axle Design Load Capacity-Drive (lbs.) 22,500
 Axle Design Load Capacity-Tag (lbs.) 14,000
 Roof Exhaust Extension 9"

Body Construction Structure:
 Integral Stainless/Rust Protected Mild Steel
 Luggage Doors: Stainless Steel Ribbed Between
 Luggage Doors and Windows; SS stretched
 Body Construction-Outer Shell:
 Stainless Steel to Bottom of Windows
 Body Construction Sub-Frame:
 Low-Alloy/High Tensile Steel
 Baggage Bay Door Interior Aluminum Lining
 Aluminum Partitions Between Baggage Compartments
 Aluminum Floor Liner in Bays

AUDIO-VIDEO

Blu-Ray DVD with Sound Bar in Salon/Bedroom/Entertainment Bay
 Stationary TV Antenna
 (1) In-Motion Satellite System
 (2) Stationary HD Satellite System
 46" LED HD Television in Bedroom on Lift
 46" LED HD Television in Entertainment Bay
 46" LED HD Television on Lift in Cab for Salon
 Crestron® System with 3 iPad Controls with Docking Station for:
 Audio/Video in Salon/Bedroom/Entertainment Bay
 XM/AM/FM Player
 Window Shades
 Lighting
 Climate Control HVAC

AIR CONDITIONING & HEATING

(4) Low Profile 13,500 BTU Roof Air Conditioner with:
 Heat Pump and Dual Control Module
 50,000 BTU Diesel Fired Boiler Hydronics System
 (3) Interior Zones and (1) Utility Bay Zone
 (7) Heat Exchangers
 Electric Heater for Plumbing Bay
 110v Electronic Heater in Step Well, Bathroom, and Kitchen Base

PLUMBING

153 Gallon Fresh Water Tank
 126 Gallon Total Holding Tanks
 63 Gallon Gray and 63 Gallon Black Water Tanks
 Driver Side Electric Dump Valves for Gray and Black Tanks
 (2) 10 Gallon Electric Water Heater with Winterization System & Motor Aide
 110v Water Pump with Accumulator Tank 65 PSI
 12v Back Up Water Pump
 Water Filtration System

BATHROOM(S)

Custom Sinks and Faucets
 Custom Shower Walls with Seat and Shampoo Caddy
 Pressure Balanced Shower Valve with Slide Bar
 Bath Accessory Package
 (2) Tecma® Toilet
 (2) Exhaust Fan
 Custom Glass Shower Door

OPTIONS

Entrance Door Bell and Camera
 Ground Effect Lights (White)
 Electric Heated Floors

EMERALD COACH X-SUPER SLIDE

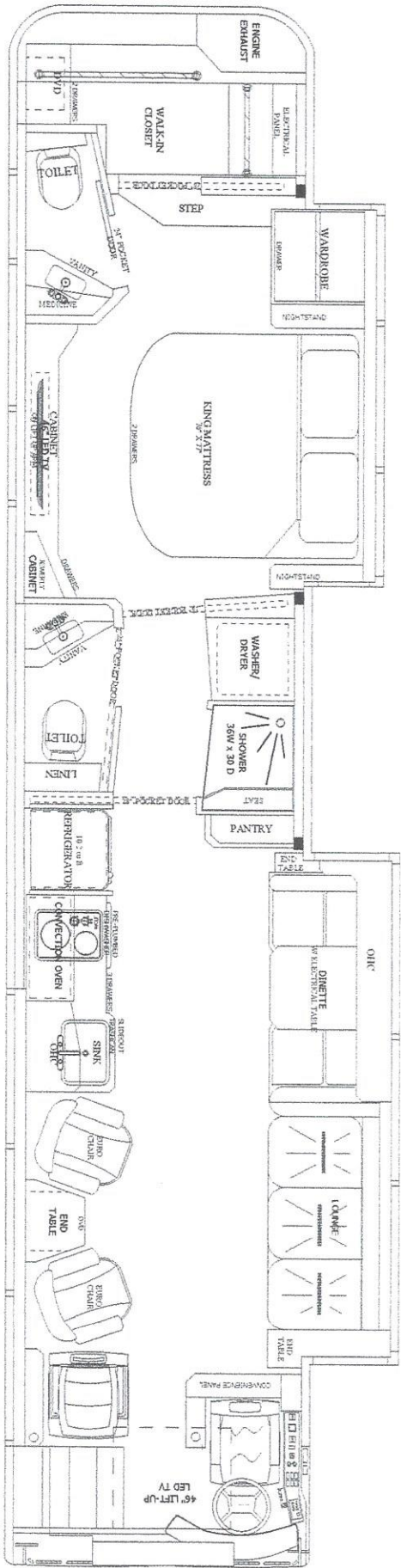

**X-5909
SUPER SLIDE**

<p>1000 Department P.O. Box 2599 Sakonville, Texas 76801 (817) 666-9299 (254) 966-9733</p>	
<p>LEADER: _____ CUSTOMER: EMERALD DESIGNER: _____ CHECKER: _____ SALES: CODY STEAD</p>	<p>REVISIONS: 01 JC - 16-JUN-18 APPROVED 02 JC - 22-JUN-18 03 JC - 07-JUL-18 FINAL</p>
<p>DATE: 06/06/18 DRAWN BY: KIMMIE GIBSON</p>	<p>THIS DRAWING IS THE PROPERTY OF EMERALD COACH. IT IS TO BE USED ONLY FOR THE PROJECT AND VEHICLE SPECIFICALLY IDENTIFIED HEREON. IT IS NOT TO BE REPRODUCED OR TRANSMITTED IN ANY FORM OR BY ANY MEANS, ELECTRONIC OR MECHANICAL, INCLUDING PHOTOCOPYING, RECORDING, OR BY ANY INFORMATION STORAGE AND RETRIEVAL SYSTEM.</p>